

**Before you begin, read all warnings and installation instructions thoroughly.**

## Safety & Warnings ⚠

- Install in accordance with the National Electric Code, and local regulations.
- This product is intended to be installed and serviced by a qualified, licensed electrician.
- This product is IP65 rated for outdoor applications when installed with a single-gang wet location switch box and gasket (box sold separately).
- Ensure applicable wire is installed between driver, fixture, and any controls in between. When choosing wire, factor in voltage drop, amperage rating, and type (in-wall rated, wet location rated, etc.). Inadequate wire installation could overheat wires, and cause a fire.
- This fixture must be grounded. Ensure to attach earth ground to the single-gang switch box.
- Do not install this product in an environment outside the listed ambient temperature.
- Do not modify or disassemble this product beyond instructions or the warranty will be void.

## Quick Specs

<b>Input Voltage</b>	100-277VAC, 50/60Hz
<b>Power Consumption</b>	1.5W / 0.125A
<b>Ambient Temperature</b>	-4° ~ 122°F (-20° ~ 50°C)

<b>Environment</b>	Outdoor / wet location / IP65
<b>Mounting</b>	Mounts in a single-gang switch box.
<b>Certifications</b>	cULus Listed (USA & Canada) Surface Mount Luminaire, UL # E336778.

For full specifications, see the 'Specification Sheet' available at the online product page.

## Installation (MATTONE MINI)

### Attach the Faceplate Package

1. Fix the faceplate (1) to the trim plate (2).
2. Fasten both faceplate (1) and trim plate (2) to MATTONE Mini light engine (3) with the included 4x mounting screws (included in faceplate packaging).

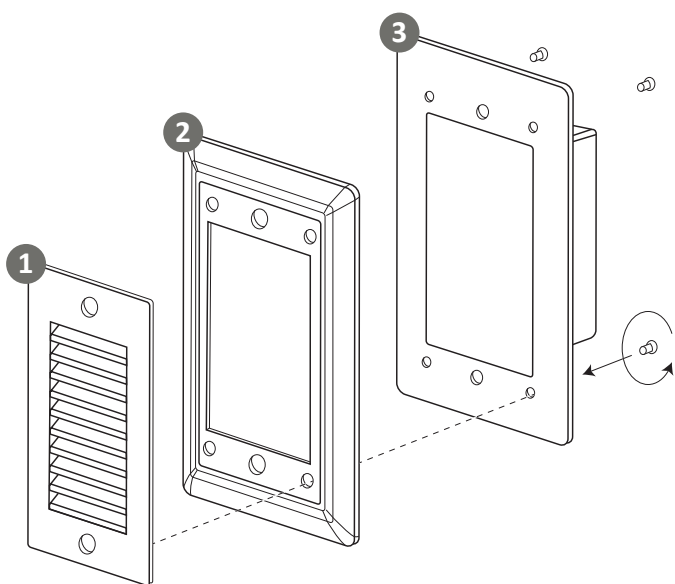

## Installation (MATTONE MINI ARCHITECTURAL)

### Attach the Faceplate Package

1. Fix the trim plate (1) to the faceplate (2).
2. Fasten both trim plate (1) and faceplate (2) to MATTONE Mini light engine (3) with the included 4x mounting screws (included in faceplate packaging).

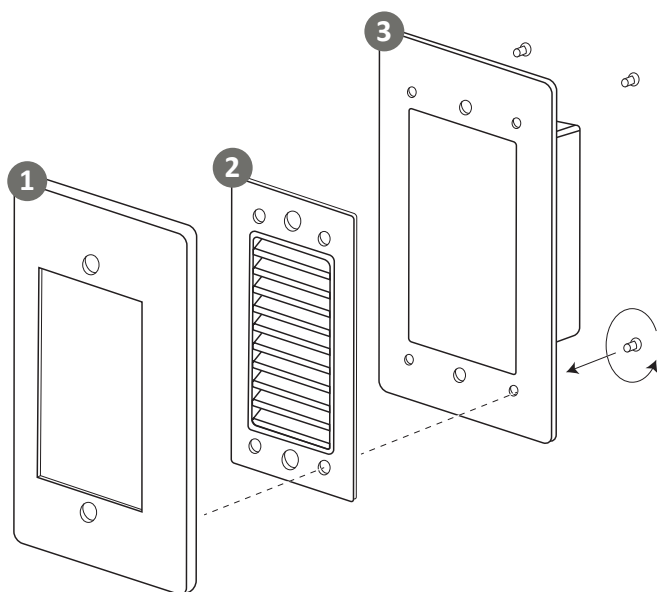

IG010215-1.1

## Installation

Install in accordance with the NEC and local regulations.



### WARNING

**Shock Hazard. May result in serious injury or death.**

Turn off power at circuit breaker before installing this product.

### Connect Wiring

1. Turn off 120-277VAC power at circuit breaker.
2. Determine applicable switch box for installation.
3. Pull main power cable through switch box and attach earth Ground to switch box chassis.
4. Attach AC Hot to fixture Hot (black). Attach AC Neutral to fixture Neutral (white).
5. Fasten fixture to switch box with included screws.
6. Turn on 120-277VAC power at circuit breaker.

